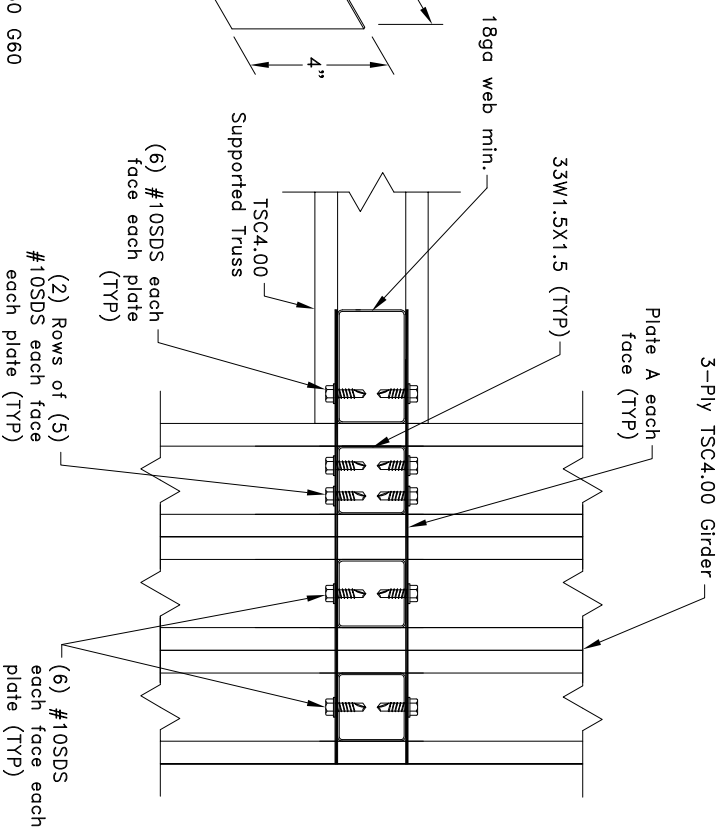

**Plate A**  
16g ASTM A653 Grade 50 G60  
Bare metal thickness:  $t = 0.0538"$



**Plan View**

$$R_v = U = 6500\#$$

## 90° Truss -to-Truss Connection for 3-Ply Girder

**TrusSteel®**  
An ITW Company

[www.TrusSteel.com](http://www.TrusSteel.com)

Florida: 1950 Marley Drive / Haines City, FL 33844 / (800) 755-6001  
Missouri: 13389 Lakefront Drive / Earth City, MO 63045 / (800) 326-4102  
California: 8351 Rovana Circle / Sacramento, CA 95828 / (800) 877-3678

### General Notes:

1. SDS = self-drilling tapping screw
2. All edge distances, end distances, and spacing are  $9/16"$  minimum.
3.  $R_v$  refers to vertical reaction, and  $U$  refers to uplift.
4. Clip fastener placement is identical on opposite side to what is shown.
5. When supported truss has a Z-Web vertical refer to TS068 for connection areas.
6. Cold-Formed Steel calculations are per the 2010 supplement to the AISI 2007 "North American Specification for the Design of Cold-Formed Steel Structural Members" (S100-07/S2-10).

### Custom Detail:

TS-CD-TT-913-002

Date:

10/20/10

### Custom Detail Category:

Truss-to-Truss Connection

ITW Building Components Group, Inc. shall not be responsible for any performance failure in a connection due to a deviation from this detail. Any variation from this detail shall be approved in advance by ITW Building Components Group, Inc.